

*****PRESS RELEASE*****

Site Work to Begin at Future Home of Port Washington Police District Headquarters

*Perimeter Fence Being Installed, Demo of Old Buildings Up Next
Preliminary Site Plan Also Becomes Available*

PORT WASHINGTON, NY (February 20, 2024) -The Port Washington Police District (PYPD) would like to notify the Port Washington community that a bid has been accepted by RFC Residential Fence Corp to install a fence around the perimeter of the District's property planned for the new headquarters. The fencing, which is expected to be completed in the coming months, will be installed to better protect the property and ensure safety for the community as demolition of existing structures is expected to begin late spring to summer.

“Activity on the site is certainly exciting as we begin to execute the preliminary site work needed to finalize plans for the new headquarters,” said PYPD Chairperson Angela Lawlor-Mullins.

“Turning these blighted properties into a community asset is going to take a significant amount of work and time, but we are committed to being good neighbors and ensure Port Washington residents always have the latest news and updates about the project.”

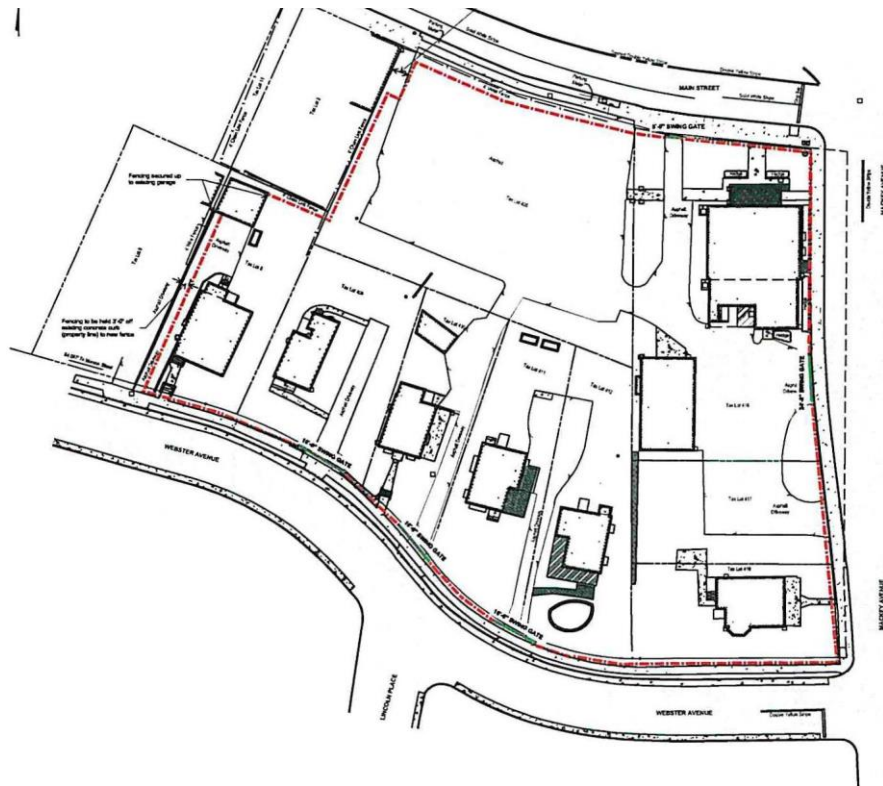

CAPTION: Red lines on the map indicate where the new perimeter fence will be installed

As the perimeter fence is being installed, the District is simultaneously soliciting a Request for Proposals (RFP) to find a qualified contractor to demolish the existing buildings on the site. The District has already undergone an extensive environmental review to ensure any potentially harmful materials currently existing within the buildings are identified and removed prior to demolition.

“There could be some dust and debris as a result of the existing building demolition, so we wanted to ensure that any materials potentially escaping the property during the process are not hazardous in any way,” said PWRD Commissioner JB Meyer. “Thankfully, the detail review completed on each of the buildings slated for demolition found minimal environmental concerns, all of which will be abated.”

Once the fencing is up and the existing buildings are demolished, the site will start to take shape and lend itself to be better visualized for its proposed plan. The District has also provided what its preliminary site plan will look like based on size needs of the new headquarters.

“The proposed positioning of the building will not only ensure this building is visible and easily identifiable from main street, but ensure its footprint exists on the portions of the property that are commercially zoned,” said PWRD Commissioner Sean McCarthy. “Our goal with the site plan and with all of the screening and buffers to be developed is to limit the visual impacts to surrounding neighbors as much as possible, while also ensuring the design of the new facility matches the charm and character of Port Washington.”



Caption: Site map of the proposed new headquarters building placement and preliminary design for the overall property.

More About the Project

The current police headquarters has reached the end of its useful life. Originally built in 1958 to accommodate 35 officers and staff, the facility has undergone several renovations and expansions over the years-with a third-party study being completed in the 1990s determining a new facility was needed. The District currently has a workforce of 80, including uniformed officers and support staff, who are crammed into spaces designed for less than half as many individuals. The original headquarters was also not designed anticipating the technology and electrical needs of a modern facility nor was it designed to be ADA compliant.

The new headquarters is being specifically designed to ensure it is as green and sustainable as possible, with the potential to become LEED certified structure. Aside from providing adequate spaces for officers and staff, the new facility will also feature a much-needed multi-purpose room, which will be used to host District meetings, trainings and community meetings for small- to mid-sized gatherings. Parking and vehicle storage has been a perennial issue with the existing facility. The new facility will boast ample space for headquarters parking as well as the storage of District vehicles and equipment.

For more information about the Port Washington Police District and the plans to build a new headquarters in the community, please visit portwashingtonpd.ny.gov/new-pwpd-hq/. Residents who have questions about this project or are interested in taking a tour of the existing headquarters to see the need for a new facility themselves are encouraged to contact newhq@pwpd.ny.gov.